

Courses and Distances  
 Down the Rayston Branch  
 S 70 E 24  
 S 65 E 75  
 99

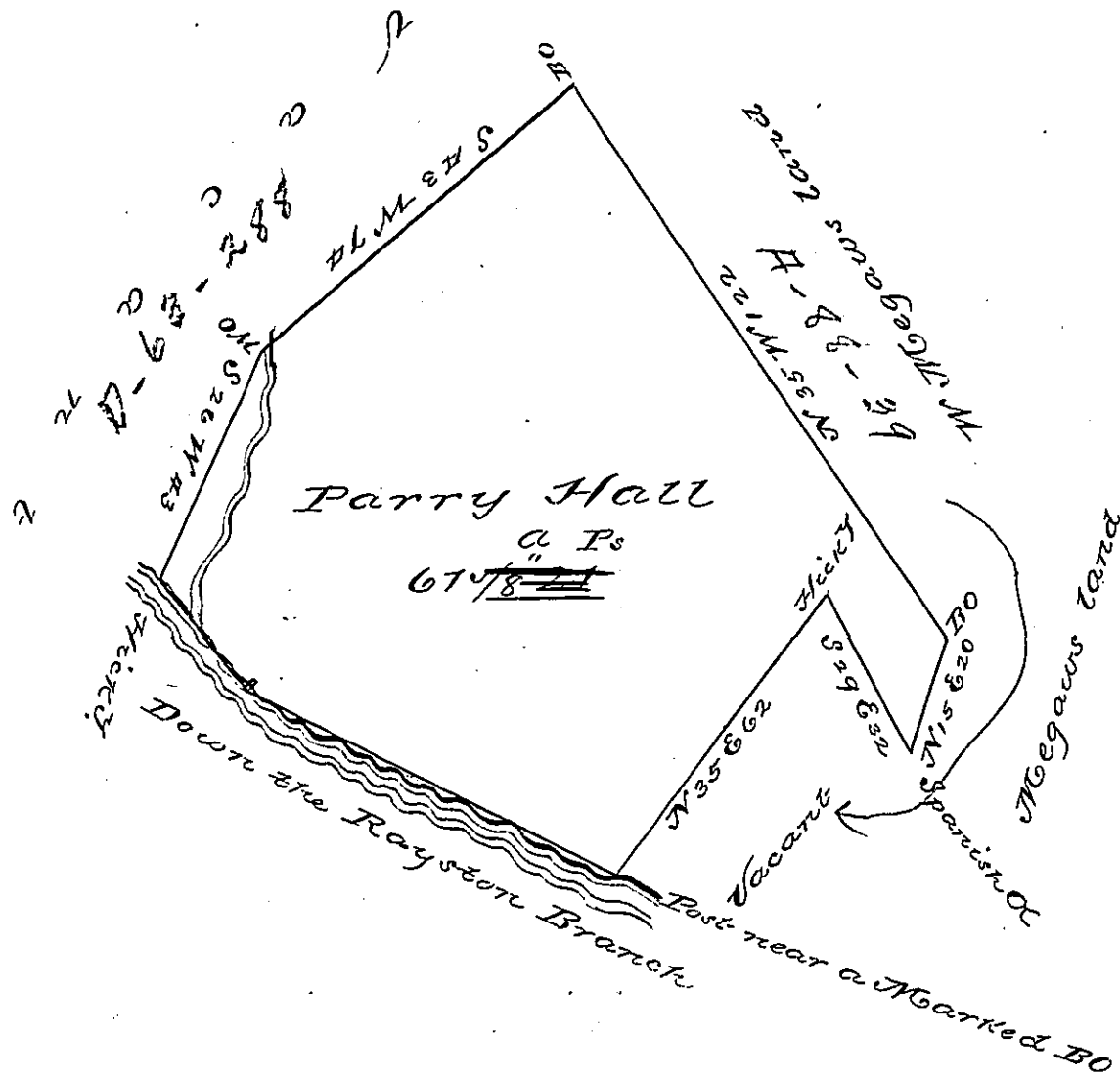

called "The Prospect,"

A Draught of a Tract of Land, Situated  
 on the Rayston Branch of Juniata in Hope-  
 well Township Bedford County Containing Six-  
 ty one Acres and Twenty one Perches and the usual  
 Allowance of Six per Cent for Roads Surveyed  
 the 10<sup>th</sup> Day of February 1786 In pursuance of a  
 Warrant - - Dated the 4<sup>th</sup> Day of April 1785

George Woods D.S.

To John Lukens Esq.<sup>r</sup>

IN TESTIMONY that the above is a copy of the original remaining on file in  
 the Department of Internal Affairs of Pennsylvania, made  
 conformably to an Act of Assembly approved the 16th day of  
 February, 1833, I have hereunto set my Hand and caused  
 the Seal of said Department to be affixed at Harrisburg,  
 this second day of August 1898

James W. Latta  
 Secretary of Internal Affairs.